

# TAP9013 – Lever pillar taps

Key:	Description:	APX size (mm):	Base material:	Colour:	QTY:
A1	Dust cap	36 x 8	Plastic	Chrome	2
A2	Crosshead screw	9 x 12.5	Brass	Brass	2
A3	Indices	24 OD x 2.5	Plastic	Red/Blue	2
A4	Handle	47 x 95	Zamak	Chrome	2
A5	Valve	53 x 24	Brass	Brass	2
B1	Body	115 x 150	Brass	Chrome	2
C1	Upper gasket	36 x 2	Rubber	White	1
C1	Lower gasket	36 x 2	Rubber	White	1
C2	Fixing nut	40 x 10.5	Plastic	Black	2

# TAP9013 – Lever pillar taps

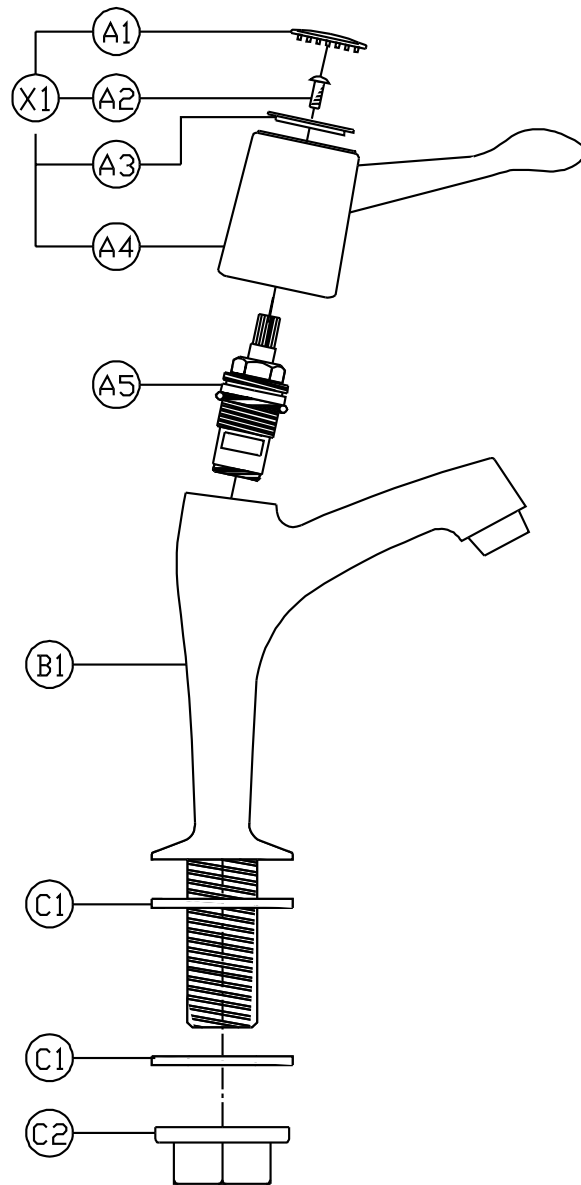

**LAMONA**  
Exclusive to Howdens Joinery Co.

**TAP9013 - Lever Pillar  
service drawing v1**

(c) abode home products ltd  
www.abode.eu

our policy is to continually  
improve and develop products,  
and accordingly we reserve the  
right to amend specifications  
without prior notice

# TAP9013 – Lever pillar taps

## General Advice:

- These instructions are intended as a guide only, if you are in any doubt you should seek the advice of a qualified professional.
- Take care not to mark finished parts with screwdrivers or other tools.
- Use a pair of rubber gloves to get a better grip on decorative hand tight parts.
- Ensure all parts are reassembled tightly.
- After maintenance test that all assemblies are water tight and function correctly.
- Always isolate the hot and cold water supplies before starting any maintenance, once isolated you should drain any residual water from your system.

## To replace the valve:

1. Lever out the dust cap (A1) using a small precision screwdriver or fingernail.
2. Unscrew the crosshead screw (A2)
3. Pull the handle (A3 & A4) away from the tap body.
4. Holding the tap body (B1) unscrew the valve (A5) using a 17mm ring spanner or adjustable wrench.
5. Clean any debris from the chamber in the tap body (B1).
6. Reassemble the tap in the reverse order.