

TAP9012 – Lever pillar taps

Key:	Description:	APX size (mm):	Base material	Colour:	QTY:
A1	Dust cap	35 x 10	Plastic	Chrome	1
A2	Handle screw	M4 x 12	Brass	Brass	1
A3	Handle indices	7 x 38	Plastic	Red or Blue	1
A4	Handle	110 x 60	Mazak	Chrome	1
A5	Valve cartridge	52 x 28	Brass	Brass	1
B1	Tap body	160 x 110	Brass	Chrome	1
C1	Lower seal	40 x 2	Rubber	Black	1
C2	Fixing backnut	11 x 25 AF	Brass	Brass	1
X1	Handle assembly	N/A	N/A	N/A	1

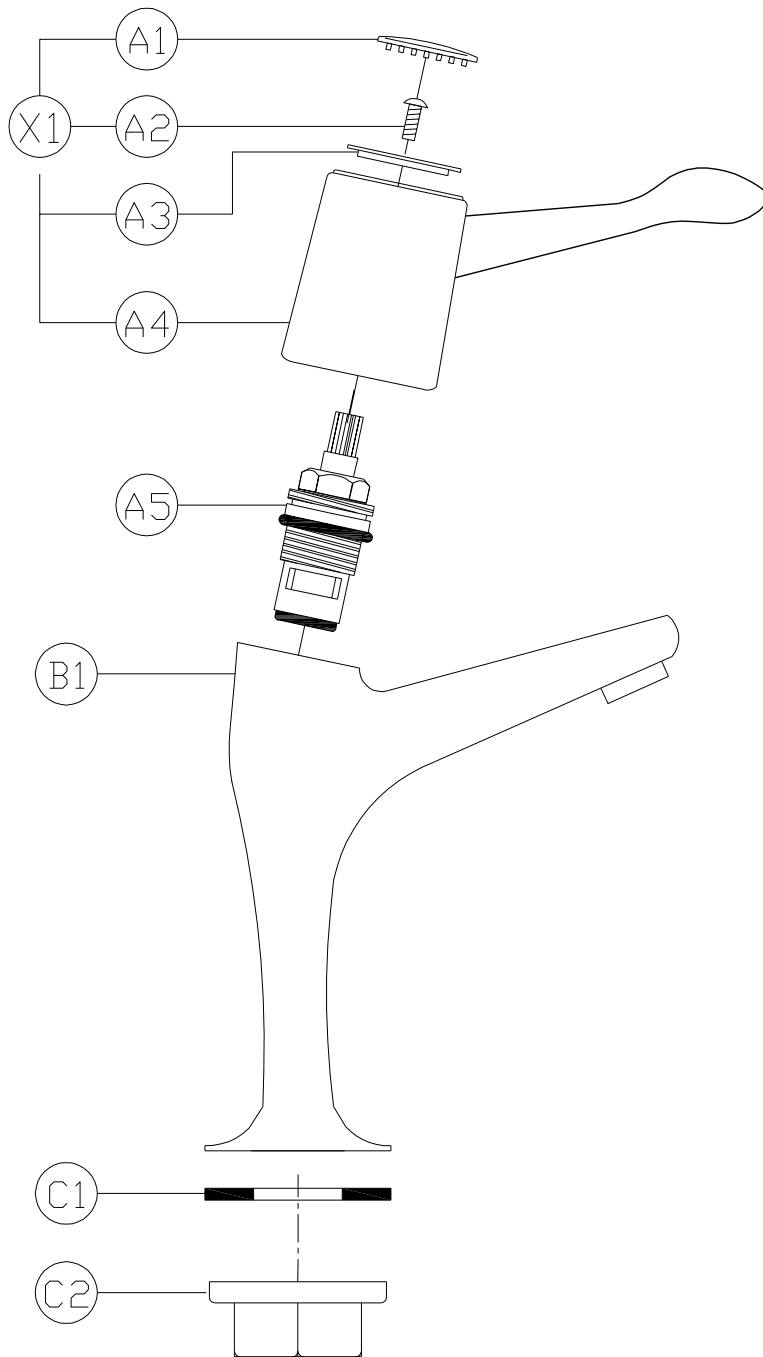

TAP9012 - Lever pillar tap service drawing v1

(c) abode home products ltd
www.abode.eu

our policy is to continually
improve and develop products,
and accordingly we reserve the
right to amend specifications
without prior notice

General Advice:

- These instructions are intended as a guide only, if you are in any doubt you should seek the advice of a qualified professional.
- Take care not to mark finished parts with screwdrivers or other tools.
- Use a pair of rubber gloves to get a better grip on decorative hand tight parts.
- Ensure all parts are reassembled tightly.
- After maintenance test that all assemblies are water tight and function correctly.
- Always isolate the hot and cold water supplies before starting any maintenance, once isolated you should drain any residual water from your system.

To replace the valve:

1. Lever out the dust cap (A1) using a small precision screwdriver or fingernail.
2. Unscrew the crosshead screw (A2)
3. Pull the handle (A3 & A4) away from the tap body.
4. Holding the tap body (B1) unscrew the valve (A5) using a 17mm ring spanner or adjustable wrench.
5. Clean any debris from the chamber in the tap body (B1).
6. Reassemble the tap in the reverse order.