

TAP3801 3811 – Antique style monobloc tap

Key:	Description:	Part No:
A1	Aerator case	
A2	flow straightener	
A3	Rubber gasket	
A4	Spout	
A5	Anti friction split ring	
A6	o-ring	
A7	o-ring	
A8	Spout locking collar	
B1	Body	
B2	Upper seal	
C1	Hot indice	
C2	Indice housing	
C3	Handle screw	
C4	Handle	
C5	Valve cover	
C6	Hot valve	
D1	Cold indice	
D2	Indice housing	
D3	Handle screw	
D4	Handle	
D5	Valve cover	
D6	Cold valve	
E1	Fixing stud	
E2	Lower gasket	
E3	Metal horseshoe	
E4	Fixing nut	
F1	Cold tail pipe	
F2	Hot tail pipe	
X1	fixing kit assembly	
X2	Flow straightener assembly	
X3	Hot handle assembly	
X4	Cold handle assembly	

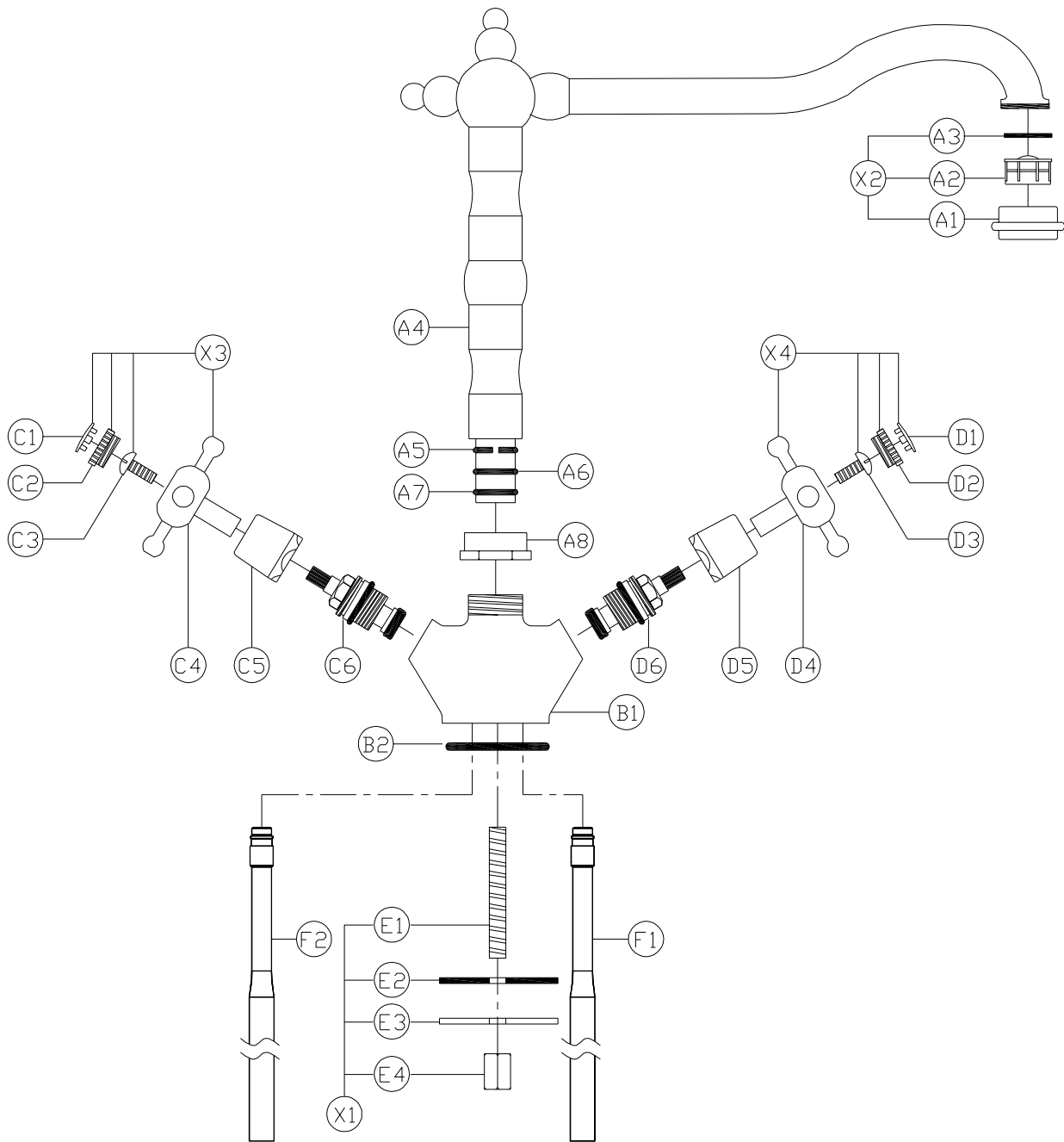

TAP3801/3811 - Antique style service drawing v2

(c) abode home products ltd
www.abode.eu

our policy is to continually improve and develop products, and accordingly we reserve the right to amend specifications without prior notice

General Advice:

- These instructions are intended as a guide only, if you are in any doubt you should seek the advice of a qualified professional.
- Take care not to mark finished parts with screwdrivers or other tools.
- Use a pair of rubber gloves to get a better grip on decorative hand tight parts.
- Ensure all parts are reassembled tightly.
- After maintenance test that all assemblies are water tight and function correctly.
- Always isolate the hot and cold water supplies before starting any maintenance, once isolated you should drain any residual water from your system.

To replace the hot valve:

1. Unscrew the indicies / dust cap (C1 & C2) by hand.
2. Unscrew the crosshead screw (C3)
3. Pull the handle (C4) away from the tap body.
4. Holding the tap body (B1) unscrew the valve (C6) using a 17mm ring spanner or adjustable wrench.
5. Clean any debris from the chamber in the tap body (B1).
6. Reassemble the tap in the reverse order.

To replace the spout o-rings:

1. Whilst holding body (B1) unscrew the spout locking collar (A8)
2. Pull the spout (A4) vertically away from the body (B1).
3. Remove the old o-rings (A6 & A7) using a small screwdriver or similar.
4. If worn, remove the white PTFE spacer (A5).
5. Ensure the inside of the body (B1) and the spout base is clean of dirt and grit with a soft wet cloth.
6. If required locate the new white PTFE spacer (A5).
7. Carefully locate the new O-rings (A6 & A7) onto the spout base.
8. Grease the O-rings (A6 & A7) thoroughly with silicone or alternative similar grease.
9. Reassemble the tap in the reverse order.