

# TAP3524 – Garda Pull Out

Key:	Description:	APX size (mm):	Base material:	Colour:	QTY:
A1	Aerator case	23.5 x 17	Brass	Chrome	1
A2	Aerator	Neoperl Honeycomb	Plastic	Grey/Light blue	1
A3	Washer	21 x 1.5	Rubber	Black	1
A4	Non-return valve	16 x 15	Plastic	White	1
A5	Non-return valve housing	29 x 18	Brass	Brass	1
A6	Pull out spout section	50 x 24	Brass	Chrome	1
A7	Rubber seal (hand spray)	22 x 2	Rubber	Black	1
A8	Rubber seal (hand spray)	22 x 2	Rubber	Black	1
A9	Spout	295 x 240 x 24	Brass	Chrome	1
A10	PTFE spacers	25 x 5	Plastic	White	2
A11	Spout rubber seals	23 x 2	Rubber	Black	2
A12	Grub screw	M3 x 4	Metal	Silver	1
B1	Body	52 DIA x 83	Brass	Chrome	1
B2	Upper seal	51 OD	Rubber	Black	1
B3	Hot valve seat	29 DIA x 20	Brass	Brass	1
B4	Cold valve seat	29 DIA x 20	Brass	Brass	1
C1	Cold valve	½" CD, length 53mm	Brass	Brass	1
C2	Valve cover	30 DIA x 37	Brass	Chrome	1
C3	Grub screw	M4 x 5	Metal	Silver	1
C4	Handle	91 x 21	Mazak	Chrome	1
D1	Hot valve	½" CD, length 53mm	Brass	Brass	1
D2	Valve cover	30 DIA x 37	Brass	Chrome	1
D3	Grub screw	M3 x 5	Steel	Silver	1
D4	Handle	91 x 21	Mazak	Chrome	1
E1	Hot flexi tail	½" BSP Male x 355mm	Stainless braided hose	Silver/Red	1
E2	Cold flexi tail	½" BSP Female x 360mm	Stainless braided hose	Silver/Blue	1
E3	Non-return valve	16 x 15	Plastic	White	1
F1	Fixing stud	110 x M12	Brass	Brass	1
F2	Stabiliser plate	88 x 58	Plastic	White	1
F3	Lower gasket	50 x 2	Rubber	Black	1
F4	Metal horseshoe	50 x 3	Metal	Silver	1
F5	Shower hose adapter	20 x 16	Brass	Brass	1
F6	Fibre washer	10 x 1.5	Fibre	Turquoise	1
F7	Horseshoe locating studs	4mm x 30mm	Brass	Brass	2
G2	Shower hose	1.5m x 13mm	Nylon	Grey	1
H1	Hose weight	43 x 30	Lead alloy	Silver	1
H2	Weight screw	M4 x 19	Steel	Silver	1

# TAP3524 – Garda Pull Out

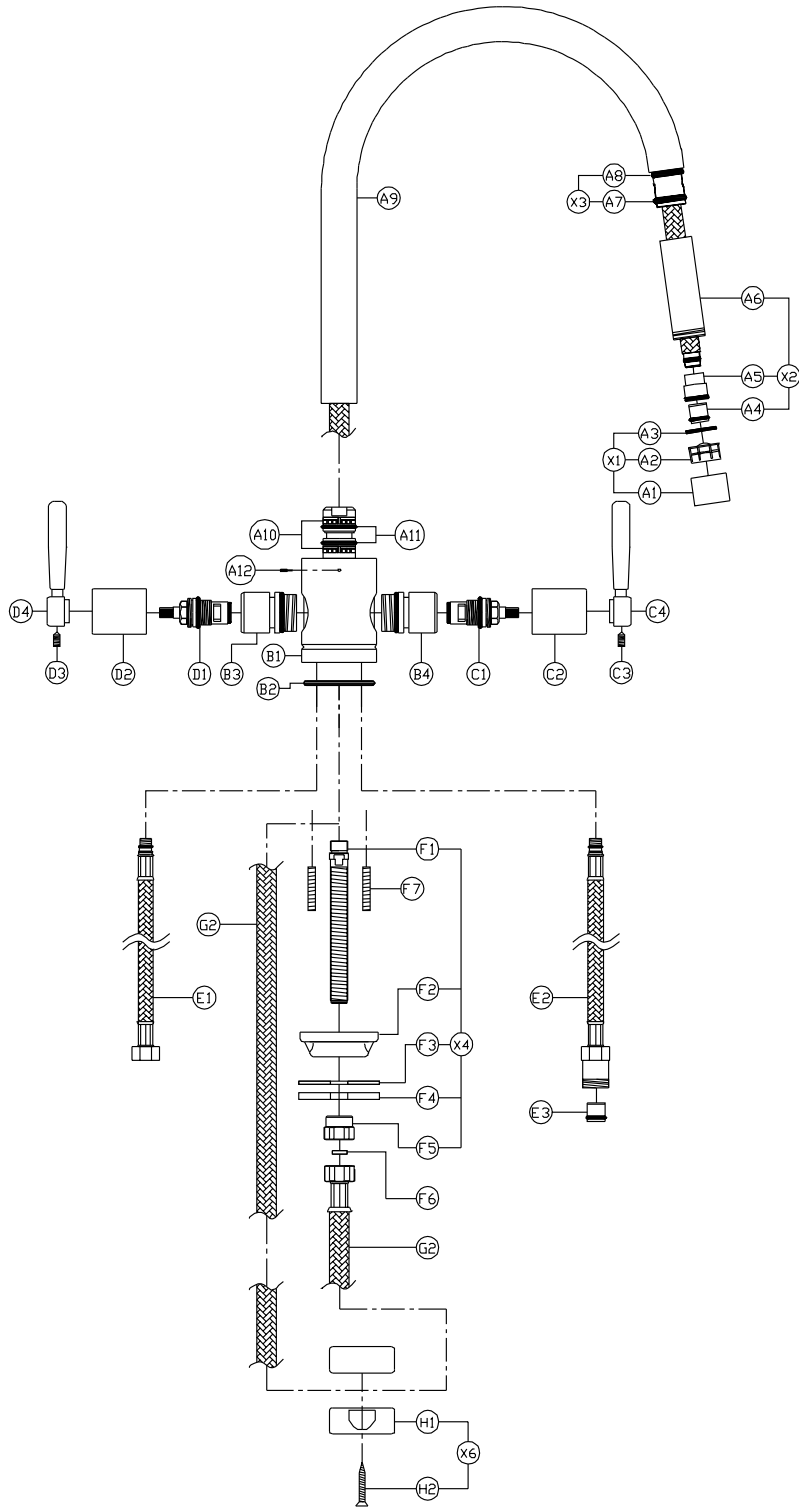

**LAMONA**  
Exclusive to Howdens Joinery Co.

TAP3524 - Garda Pull Out  
service drawing v1

our policy is to continually improve and develop products, and accordingly we reserve the right to amend specifications without prior notice

# TAP3524 – Garda Pull Out

## General Advice:

- These instructions are intended as a guide only, if you are in any doubt you should seek the advice of a qualified professional.
- Take care not to mark finished parts with screwdrivers or other tools.
- Use a pair of rubber gloves to get a better grip on decorative hand tight parts.
- Ensure all parts are reassembled tightly.
- After maintenance test that all assemblies are water tight and function correctly.
- Always isolate the hot and cold water supplies before starting any maintenance, once isolated you should drain any residual water from your system.

## To replace the hot valve:

1. Loosen grub screw (D3) on the underside of handle (D4) using a 2mm A/F Allen key.
2. Pull the handle (D4) horizontally away from the tap. Note: a plastic spacer may come out with the handle, if so replace when reassembling.
3. Unscrew the valve cover (D2) by hand, if necessary use a pair of rubber gloves to get a better grip.
4. Hold the body of the tap (B1) firmly. Using an adjustable or 17mm ring spanner unscrew the valve (D1).
5. Clean the Inside of chamber (B3) with a soft wet cloth.
6. Reassemble the tap in the reverse order.