

TAP2432 – Atomix

Key:	Description:	APX size (mm):	Base material:	Colour:	QTY:
A1	Aerator housing		Brass	Chrome	1
A2	Aerator		Plastic	White	1
A3	Rubber gasket		Rubber	Black	1
A4	Spout		Brass	Chrome	1
B1	Handle		Mazack	Chrome	1
B2	Hot / cold indices		Plastic	Red / blue	1
B3	Grub screw		Steel	Steel	1
B4	Valve shroud		Abs	Chrome	1
B5	Valve locking nut		Brass	Brass	1
B6	Valve cartridge		Plastic	Blue & white	1
C1	Upper body		Brass	Chrome	1
C2	Anti friction ring		Plastic	White	1
C3	O-ring		Rubber	Black	1
C4	O-ring		Rubber	Black	1
C5	Anti friction ring		Plastic	White	1
C6	Inner body		Brass	Brass	1
D1	Base plinth		Brass	Brass	1
D2	Upper seal		Rubber	Black	1
D3	Fixing stud		Steel	Silver	1
D4	Lower gasket		Rubber	Black	1
D5	Metal horseshoe		Steel	Silver	1
D6	Fixing nut		Brass	Brass	1
X5	Fixing kit assembly		N/A	N/A	1
F1	Cold inlet pipe		Copper	Copper	1
F2	Hot inlet pipe		Copper	Copper	1
X1	Handle assembly		N/A	N/A	1
X2	Aerator assembly		N/A	N/A	1
X3	Spout assembly		N/A	N/A	1
X4	Spout seal kit		N/A	N/A	1

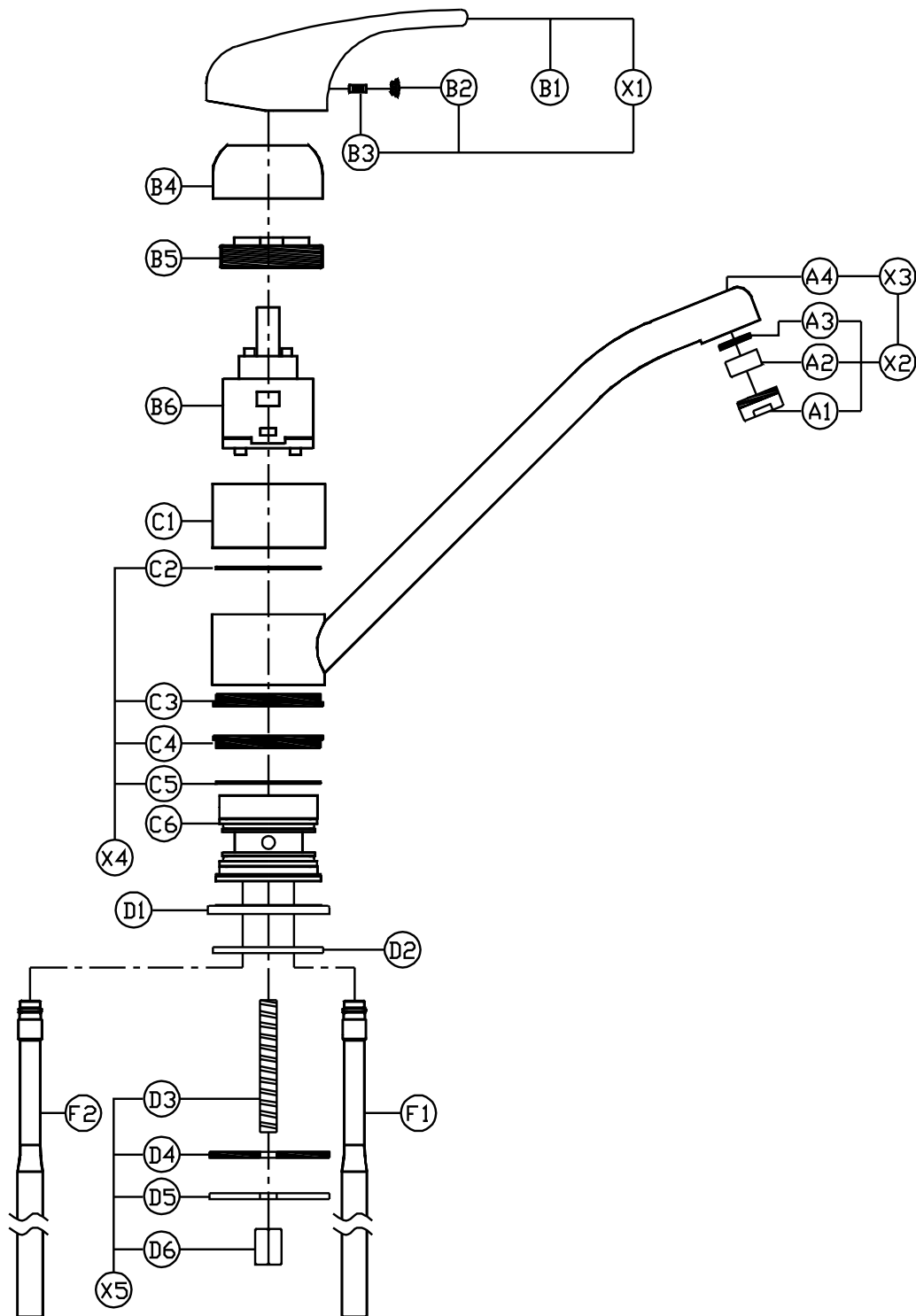

TAP 2432- atomix service drawing v1

(c) abode home products ltd
www.abode.eu

our policy is to continually
improve and develop products,
and accordingly we reserve the
right to amend specifications
without prior notice

General Advice:

- These instructions are intended as a guide only, if you are in any doubt you should seek the advice of a qualified professional.
- Take care not to mark finished parts with screwdrivers or other tools.
- Use a pair of rubber gloves to get a better grip on decorative hand tight parts.
- Ensure all parts are reassembled tightly.
- After maintenance test that all assemblies are water tight and function correctly.
- Always isolate the hot and cold water supplies before starting any maintenance, once isolated you should drain any residual water from your system.

To replace the valve:

1. Tilt the handle (B1) into the on position.
2. Remove the dust cap (B2) with a fingernail or small screwdriver.
3. Loosen grub screw (B3) using a 2.5mm A/F Allen key.
4. Pull the handle (B1) horizontally away from the tap.
5. Unscrew by hand the decorative cover (B4)
6. Hold the body of the tap (C1) firmly. Using an adjustable spanner unscrew the valve lock nut (B5).
7. Pull the old valve cartridge (B6) away from the tap.
8. Ensure that the valve chamber (C1) is clean of dirt and grit.
9. Place the new valve (B6) in the chamber (C1), ensuring the locators on the base of valve (B6) align with the recesses in the chamber of the tap (C1).
10. Reassemble the tap in the reverse order.

To replace the spout o-rings:

Please note that section (C1) is now semi permanently thread locked to the inner body (C6) to prevent accidental loosening on installation. For this reason you will need some level of force to unscrew it, you should wrap a cloth, rubber strip or similar onto section (C1) to prevent it being marked during disassembly.

1. Hold section (C1) firmly and unscrew it anticlockwise proceed to step 5, Otherwise follow steps 2 to 5.
2. Disconnect tail pipes (F1 & F2) from the supply pipes.
3. Unscrew fixing nut (D6). Pull the tap upwards away from the taphole.
4. Place a spanner across the base of body inner (C6) or the top of both tail pipes (F1 & F2) and unscrew anticlockwise section (C1).
5. Pull the spout (A4) vertically away from the body (C6).
6. Remove the old o-rings (C3 & C4) using a small screwdriver or similar. Note the orientation of the o-rings for reassembly.
7. If worn, remove the white PTFE spacers (C2 & C5).
8. Ensure the inside of the spout (A4) and the body (C6) is clean of dirt and grit.
9. If required locate the new white PTFE spacers (C2 & C5).
10. Carefully locate the new O-rings (C3 & C4) onto the body (C6).
11. Grease the O-rings thoroughly with silicone or alternative similar grease.
12. Reassemble the tap in the reverse order.