

# TAP2422 – Arno single lever

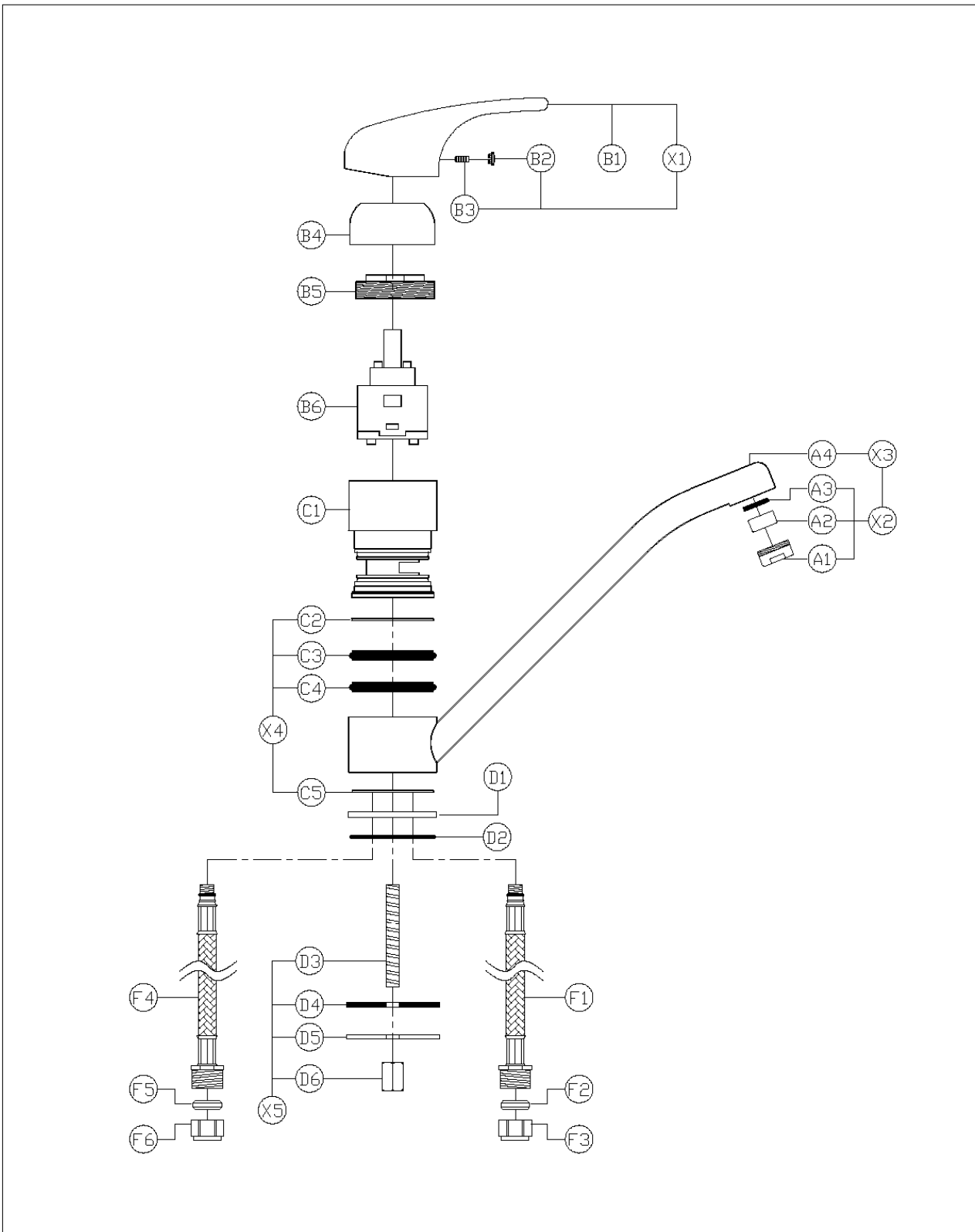

## TAP 2422- Arno service drawing v1

(c) abode home products ltd  
www.abode.eu

our policy is to continually  
improve and develop products,  
and accordingly we reserve the  
right to amend specifications  
without prior notice

### **General Advice:**

- These instructions are intended as a guide only, if you are in any doubt you should seek the advice of a qualified professional.
- Take care not to mark finished parts with screwdrivers or other tools.
- Use a pair of rubber gloves to get a better grip on decorative hand tight parts.
- Ensure all parts are reassembled tightly.
- After maintenance test that all assemblies are water tight and function correctly.
- Always isolate the hot and cold water supplies before starting any maintenance, once isolated you should drain any residual water from your system.

### **To replace the valve:**

1. Tilt the handle (B1) into the on position.
2. Remove the dust cap (B2) with a fingernail or small screwdriver.
3. Loosen grub screw (B3) using a 2.5mm A/F Allen key.
4. Pull the handle (B1) vertically away from the tap.
5. Unscrew by hand the decorative cover (B4)
6. Hold the body of the tap (C1) firmly. Using an adjustable spanner unscrew the valve lock nut (B5).
7. Pull the old valve cartridge (B6) away from the tap.
8. Ensure that the valve chamber (C1) is clean of dirt and grit.
9. Place the new valve (B6) in the chamber (C1), ensuring the locators on the base of valve (B6) align with the recesses in the chamber of the tap (C1).
10. Reassemble the tap in the reverse order.

### **To replace the spout o-rings:**

1. Disconnect the flexible tail pipes (F4 & F1).
2. Loosen fixing nut (D6) and then remove the tap entirely from the sink.
3. Hold section (C1) firmly and unscrew the base plinth (D1) anticlockwise.
4. Pull the spout (A4) vertically down away from the body (C1).
5. Remove the old o-rings (C3 & C4) using a small screwdriver or similar. Note the orientation of the o-rings for reassembly.
6. If worn, remove the white PTFE spacers (C2 & C5).
7. Ensure the inside of the spout (A4) and the body (C1) is clean of dirt and grit.
8. If required locate the new white PTFE spacer (C2).
9. Carefully locate the new O-rings (C3 & C4) onto the body (C1). Grease the O-rings thoroughly with silicone or alternative similar grease.
10. Push the spout (A4) vertically up onto the body (C1).
11. If required locate the new white PTFE spacer (C5).
12. Hold section (C1) and screw the base plinth (D1) on firmly clockwise.
13. reconnect and locate the tap in the reverse order.