

TAP2102 – Deck mixer tap

Key:	Description:	Part No:
A1	Spout	
A2	O-rings	
A3	Grub screw	
B1	Tap body	
B2	Inlet leg seal	
B3	Inlet leg	
C1	Dust cap	
C2	Handle screw	
C3	Hot indices	
C4	Handle	
C5	Hot valve	
D1	Dust cap	
D2	Handle screw	
D3	Cold indices	
D4	Handle	
D5	Cold valve	
E1	Upper seal	
E2	Fixing nut	
X1	Hot handle assembly	
X2	Cold handle assembly	

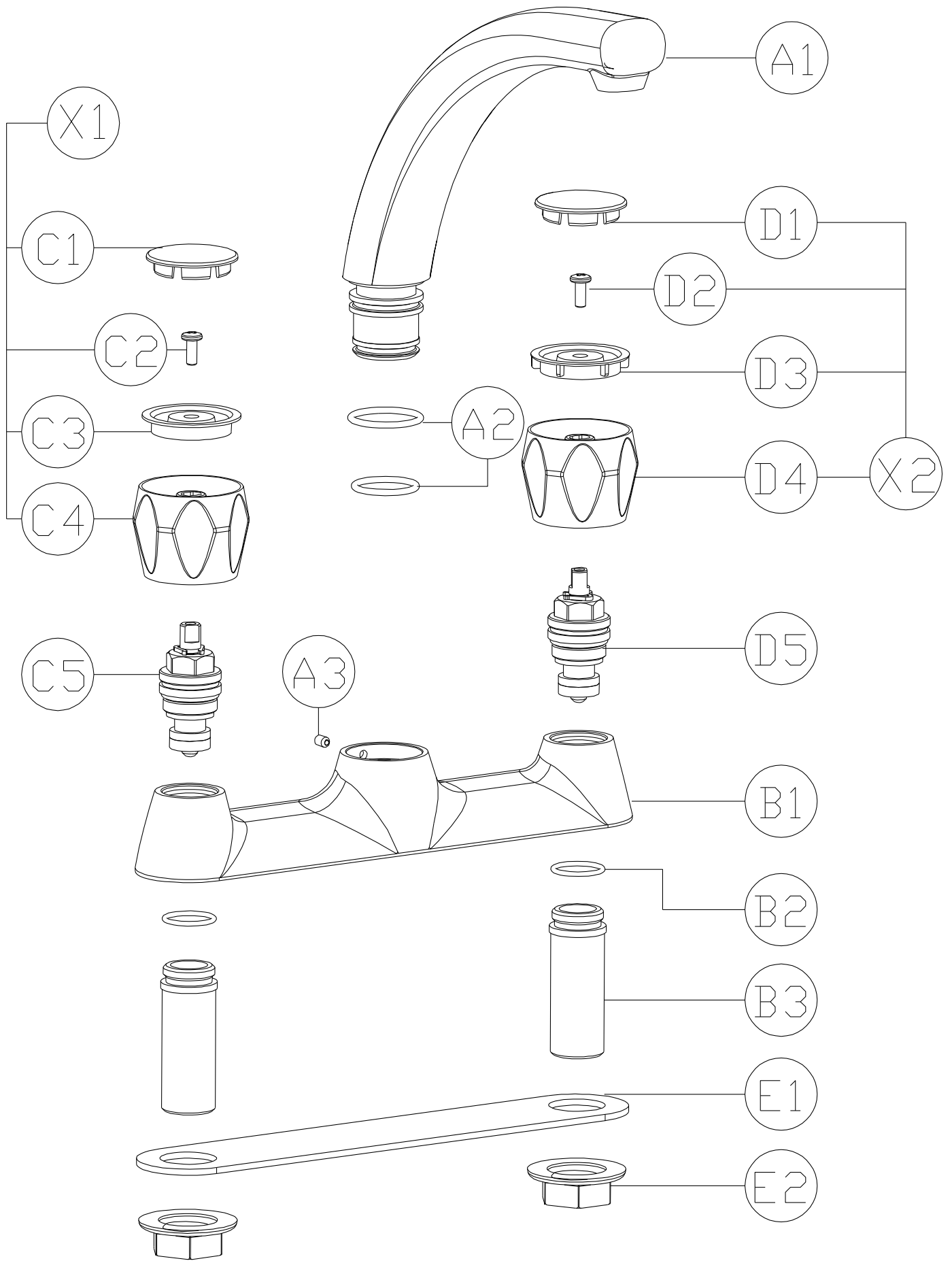

General Advice:

- These instructions are intended as a guide only, if you are in any doubt you should seek the advice of a qualified professional.
- Take care not to mark finished parts with screwdrivers or other tools.
- Use a pair of rubber gloves to get a better grip on decorative hand tight parts.
- Ensure all parts are reassembled tightly.
- After maintenance test that all assemblies are water tight and function correctly.
- Always isolate the hot and cold water supplies before starting any maintenance, once isolated you should drain any residual water from your system.

To replace the hot valve:

1. Lever out the dust cap (C1) using a small precision screwdriver or fingernail.
2. Unscrew the crosshead screw (C2)
3. Pull the handle (C3 & C4) away from the tap body.
4. Holding the tap body (B1) unscrew the valve (C5) using a 17mm ring spanner or adjustable wrench.
5. Clean any debris from the chamber in the tap body (B1).
6. Reassemble the tap in the reverse order.

To replace the spout o-rings:

1. unscrew the spout grub screw (A3)
2. Pull the spout (A1) vertically away from the body (B1).
3. Remove the old o-rings (A2) using a small screwdriver or similar.
4. Ensure the inside of the body (B1) and the spout base (A1) is clean of dirt and grit with a soft wet cloth.
5. Carefully locate the new O-rings (A2) onto the spout base (A1).
6. Grease the O-rings (A2) thoroughly with silicone or alternative similar grease.
7. Reassemble the tap in the reverse order.