

TAP1118 – Pillar taps

Key:	Description:	APX size (mm):	Base material:	Colour:	QTY:
A1	Dust cap	36 x 8	Plastic	Chrome	2
A2	Crosshead screw	9 x 12.5	Brass	Brass	2
A3	Indices	24 OD x 2.5	Plastic	Red/Blue	2
A4	Handle	45 x 34	Zamak	Chrome	2
A5	Valve	53 x 24	Brass	Brass	2
B1	Body	115 x 150	Brass	Chrome	2
C1	Upper gasket	36 x 2	Rubber	White	1
C1	Lower gasket	36 x 2	Rubber	White	1
C2	Fixing nut	40 x 10.5	Plastic	Black	2

TAP1118 – Pillar taps

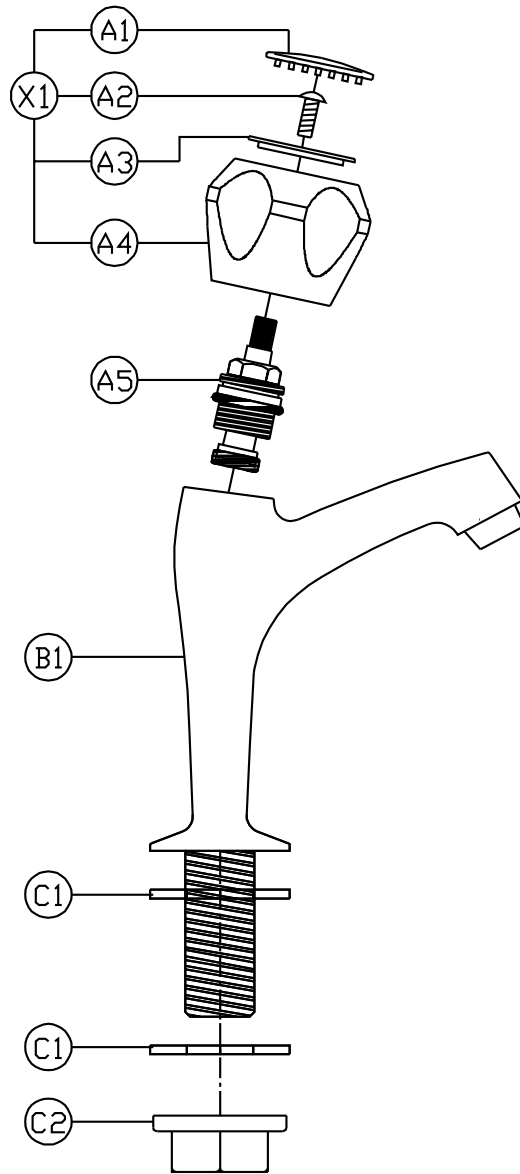

LAMONA
Exclusive to Howdens Joinery Co.

TAP1118 - Pillar service drawing v1

(c) abode home products ltd
www.abode.eu

our policy is to continually
improve and develop products,
and accordingly we reserve the
right to amend specifications
without prior notice

TAP1118 – Pillar taps

General Advice:

- These instructions are intended as a guide only, if you are in any doubt you should seek the advice of a qualified professional.
- Take care not to mark finished parts with screwdrivers or other tools.
- Use a pair of rubber gloves to get a better grip on decorative hand tight parts.
- Ensure all parts are reassembled tightly.
- After maintenance test that all assemblies are water tight and function correctly.
- Always isolate the hot and cold water supplies before starting any maintenance, once isolated you should drain any residual water from your system.

To replace the valve:

1. Lever out the dust cap (A1) using a small precision screwdriver or fingernail.
2. Unscrew the crosshead screw (A2)
3. Pull the handle (A3 & A4) away from the tap body.
4. Holding the tap body (B1) unscrew the valve (A5) using a 17mm ring spanner or adjustable wrench.
5. Clean any debris from the chamber in the tap body (B1).
6. Reassemble the tap in the reverse order.